

ADMINISTRATIVE BOUNDARIES

	Municipality or Regional District		Indian Reserve
	Park or Protected Area		First Nations Treaty Land
	Private Parcel		Provincial Border

	Freeway or Highway		Transmission Line or Pipeline
	Arterial Collector		Railway Crossing
	Local Road		Highway Rest Stop
	Unpaved Road		Airport
	Ferry Route		Heliport

	Ministry of Forests Land and Natural Resource Operations Radio Repeaters
	BC Recreation Sites (Campgrounds and Picnic Areas)
	Nursery, Orchard, or Vineyard
	Ice Field or Snow Field
	Swamp or Marsh
	Wooded Area
	Built Up Areas
	Hospital Properties
	Building
	Police
	Fire Hall
	Ambulance
	Shipyard or Terminal
	Port or Harbour

 100 Metre Interval Contour Depression
 20 Metre Interval Spot Height

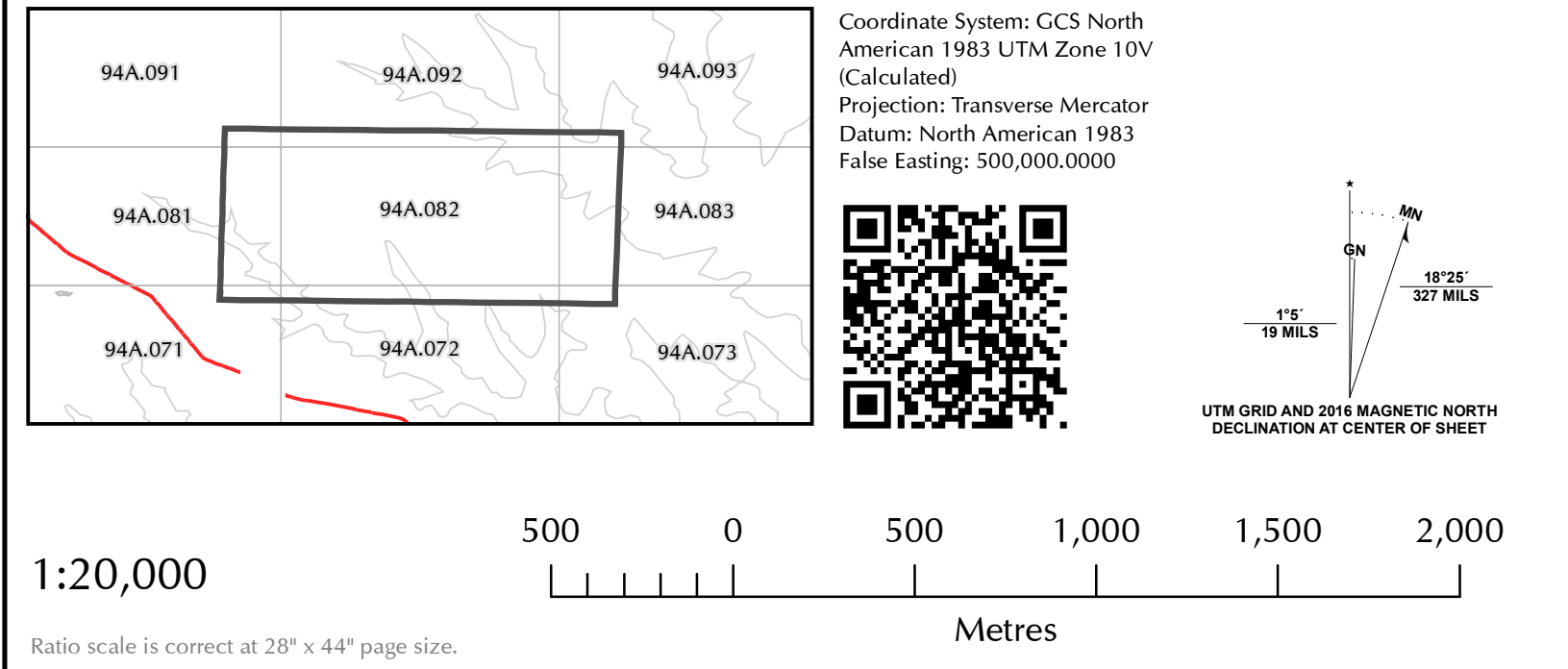
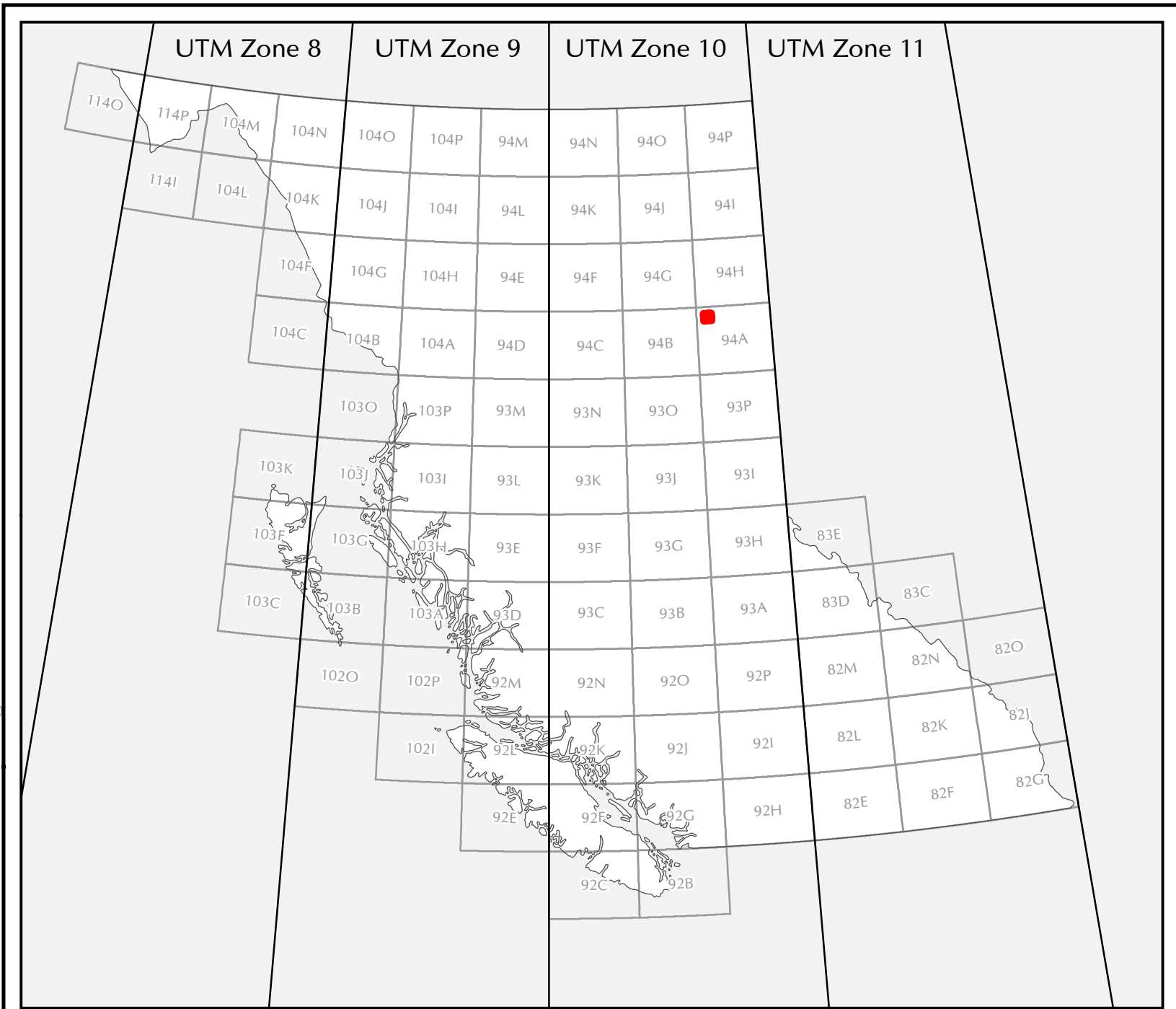

DATA SOURCE
This map is produced by GeoBC of the Ministry of Forests, Lands, and Natural Resource Operations. It is based on the most current TRIM (Terrain Resource Information Mapping) data available. TRIM data is generally accurate to 10m. This map also contains BC Hydro transmission lines, FLNRO repeater tower locations and various public building locations derived from the Digital Road Atlas. For more information on the data, the TRIM specification or other base mapping products, please visit the GeoBC website at www.geobc.gov.bc.ca.

LICENCE AND OWNERSHIP
Copyright © 2016, Province of British Columbia. All rights reserved. This material is owned by the Government of British Columbia and protected by copyright law. It may not be reproduced or redistributed without the prior written permission of the Province of British Columbia.

DISCLAIMER AND WARNING

The Province of British Columbia makes no representations or warranties regarding the accuracy, merchantability, fitness for a particular purpose, or completeness of any information contained in or otherwise comprising this map. Without limiting the foregoing, you are warned not to use this map for navigational purposes. This map may be generalized and may not reflect current conditions. Uncharted hazards may exist.